

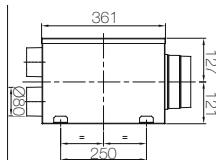

## PLMP 150 10X75

Plenum di distribuzione, 1 ingresso  $\text{\O}150\text{mm}$ , 10 uscite  $\text{\O}80\text{mm}$  (per condotto CNDFLB 75/63) e 11 tappi di protezione/chiusura in dotazione.

Modello	PLMP 150 10X75
Codice	VMCONS0003

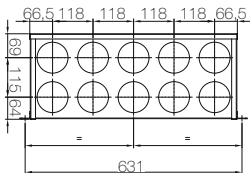
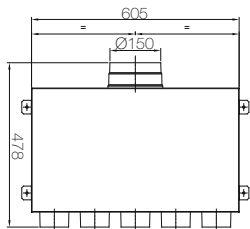

Dimensioni in mm

